

HONDA
XR650

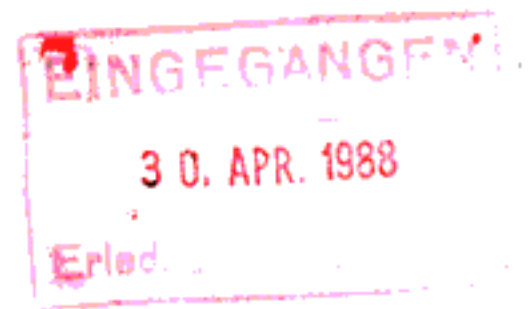

Set-up Instructions

Instructions de préparation

Montageanleitung

Istruzioni di preparazione

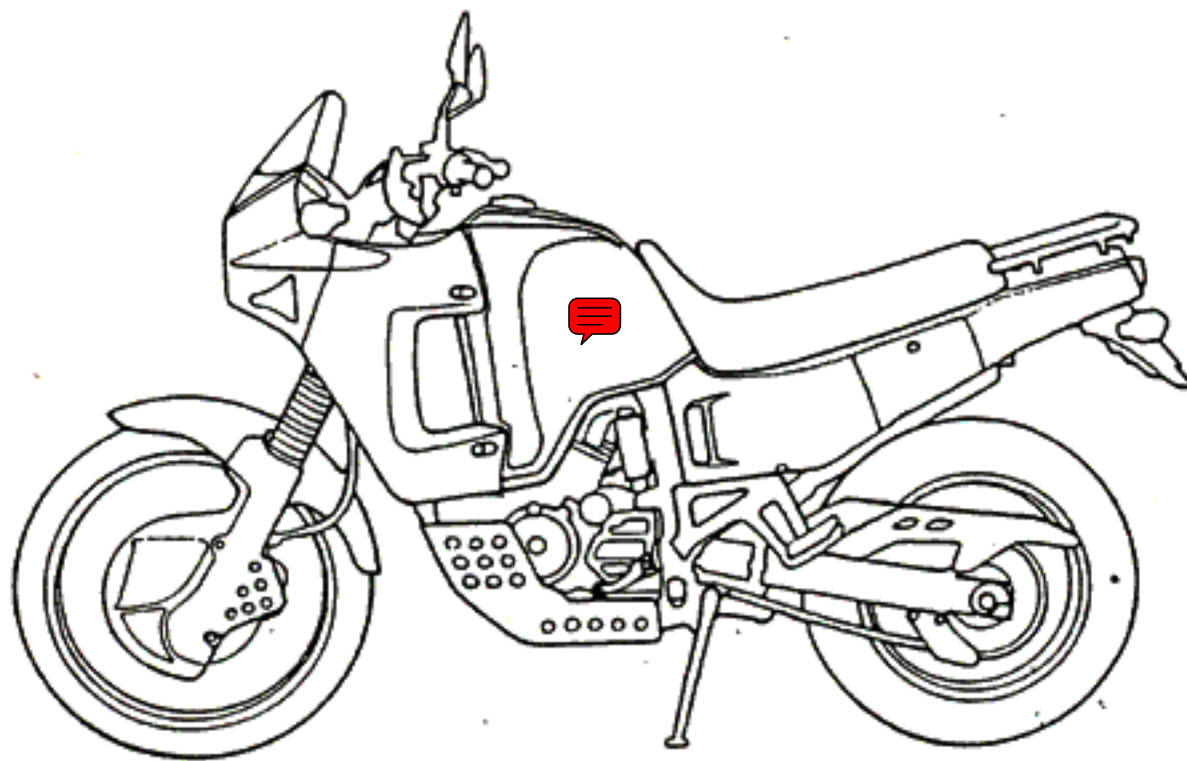

© HONDA MOTOR CO., LTD. 1988

J

WWW.XR650STORY.EU ARCHIVE

Throughout this manual, the following abbreviations are used to identify individual models:

G	Germany	IT	Italy
F	France	SP	Spain
SW	Switzerland	PO	Portugal
B	Belgium	FI	Finland
AR .	Austria		

Dans ce manuel, les abréviations suivantes sont utilisées pour identifier les différents modèles:

G	Allemagne	IT	Italie
F	France	SP	Espagne
SW	Suisse	PO	Portugal
B	Belgique	FI	Finlande
AR	Autriche		

Zur Identifizierung der einzelnen Modelle werden innerhalb dieses Handbuchs die folgenden Abkürzungen verwendet:

G	Deutschland	IT	Italien
F	Frankreich	SP	Spanien
SW	Schweiz	PO	Portugal
B	Belgien	FI	Finnland
AR	Österreich		

▲WARNING

SET-UP AND PRE-DELIVERY SERVICE MUST BE PERFORMED BY AN AUTHORIZED HONDA DEALER. Proper set up and pre-delivery service is essential to rider safety and reliability of the motorcycle. When a customer takes delivery of his brand new motorcycle, he expects it to be in excellent running condition. There are few things that will cause greater customer dissatisfaction than poor preparation of a new motorcycle. An error or oversight made by the mechanic assembling and servicing a new unit can easily result in fault operation, damage to the machine, or even injury to the rider.













CAUTION:

- Take every precaution when removing the shipping crate not to damage the motorcycle.
- The torque values and sizes of bolts and nuts are also indicated below the work sequence number when or deemed necessary. The other bolts, screws and nuts must be tightened to the standard torques.
- Some parts may differ in shape from those illustrated according to market differences.
- After the motorcycle has been set up, perform the pre-delivery inspections as described in the PRE-DELIVERY SERVICE CHECKLIST at the back of manual.
- Refer to owner's manual for specifications and detailed procedures. Always test ride the unit to make sure that it is functioning properly.

HOW TO USE THIS MANUAL

- Each loose part is indexed to the work sequence number ([1][2]...). Install or remove the loose parts in the order indicated.
- Tally all loose parts with the Parts List in the manual.

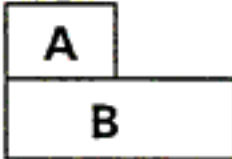
SYMBOLS USED IN THIS MANUAL

- | | |
|--|---|
|  : Coat with engine oil |  : Choke cable |
|  : Push through |  : Front brake hose or cable |
|  : Engage into |  : Clutch hose or cable |
|  : Torque to 10 N·m (1.0 kg-m, 7 ft-lb) |  : Throttle cable |
| 10 (1.0, 7) |  : Speedometer cable |
|  : Use this type of bolt or screw
(diameter x length mm)
(Example) (diameter mm) or size not listed |  |
|  : Size of nuts (diameter mm) | A : Work sequence number |
| | B : Size of bolt, screw or nut, and torque value |
| | [1] : These numbers represent INSTALLATION sequence. |
| |  : White numbers on black ground represent DISASSEMBLY sequence. |

(1)

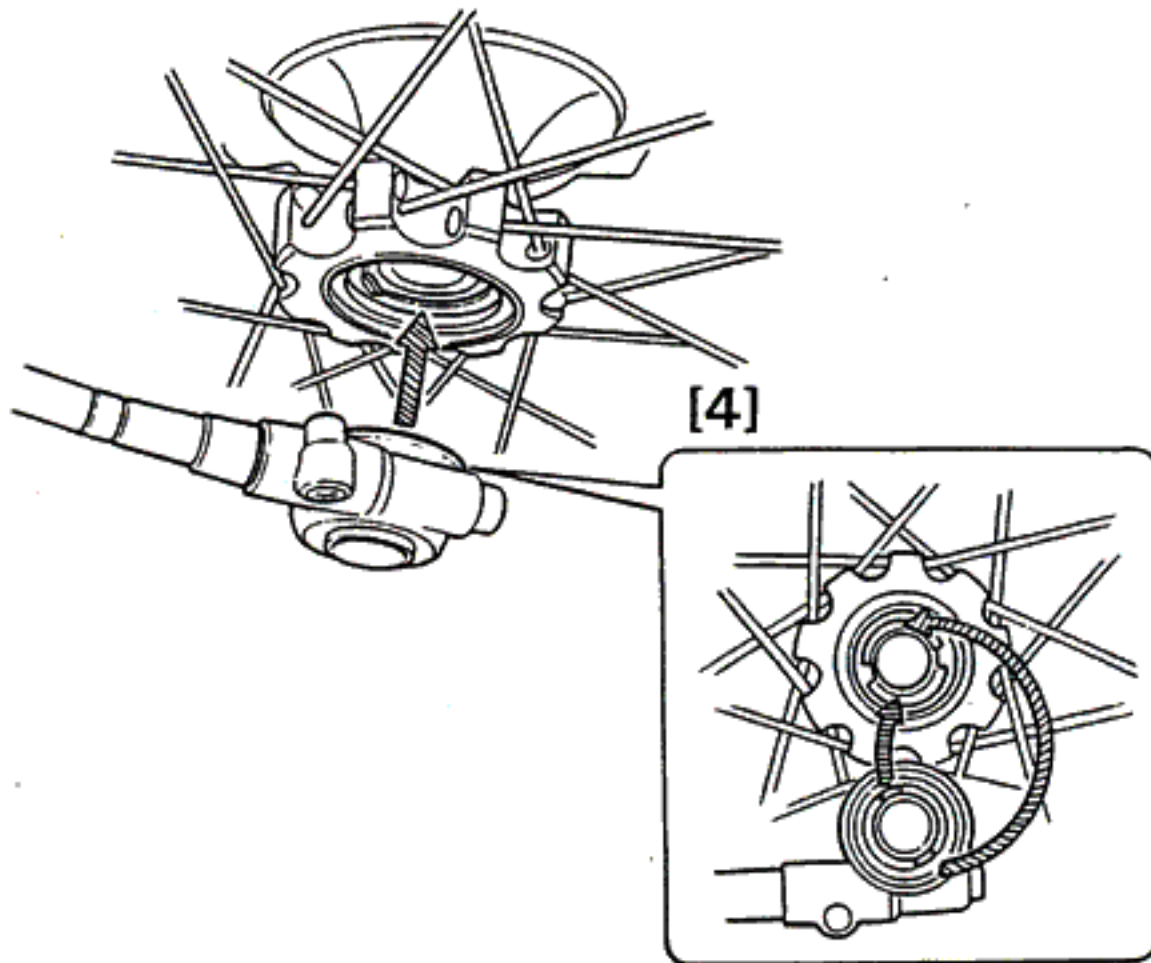
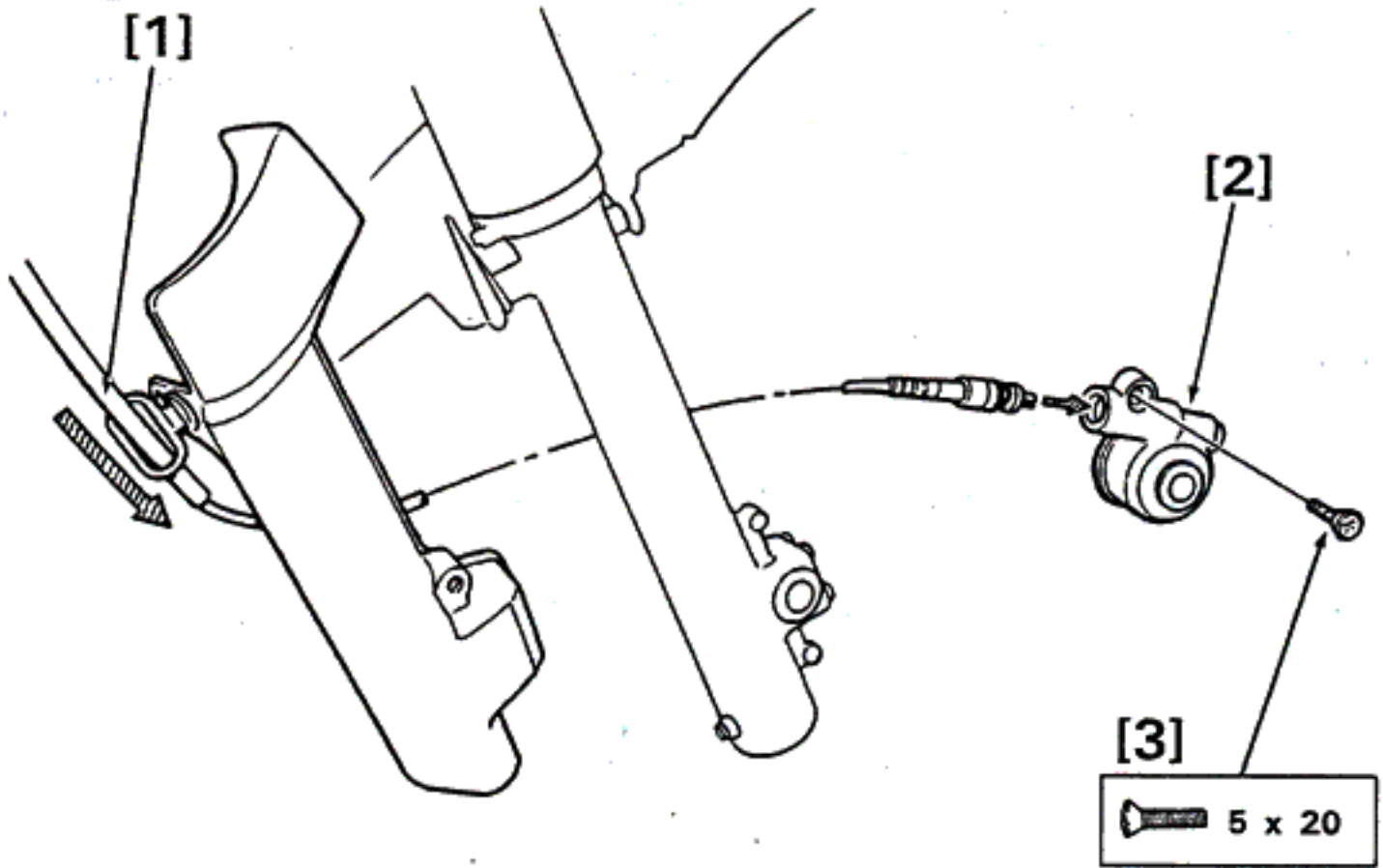

(2)

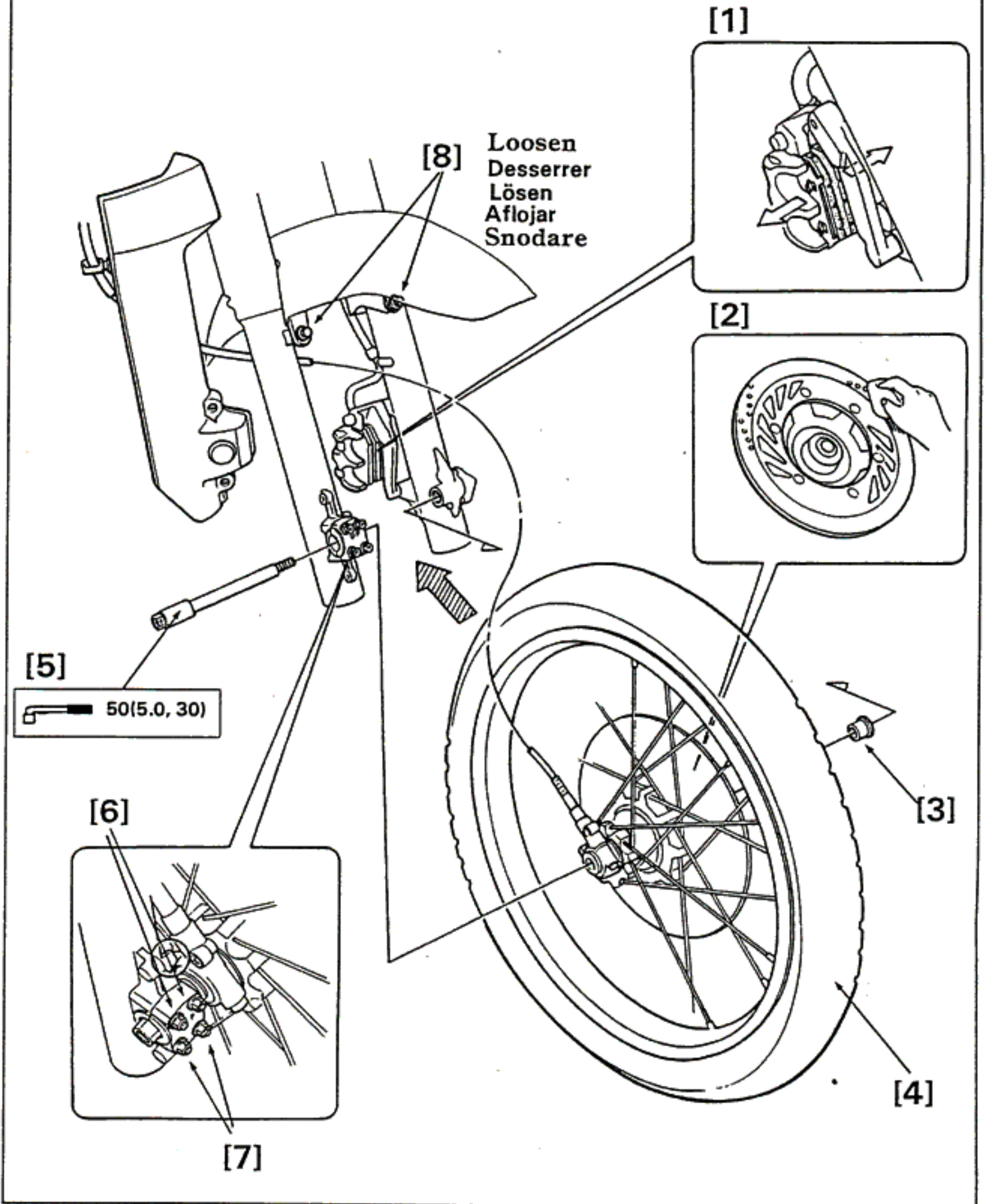

(3)

[1]

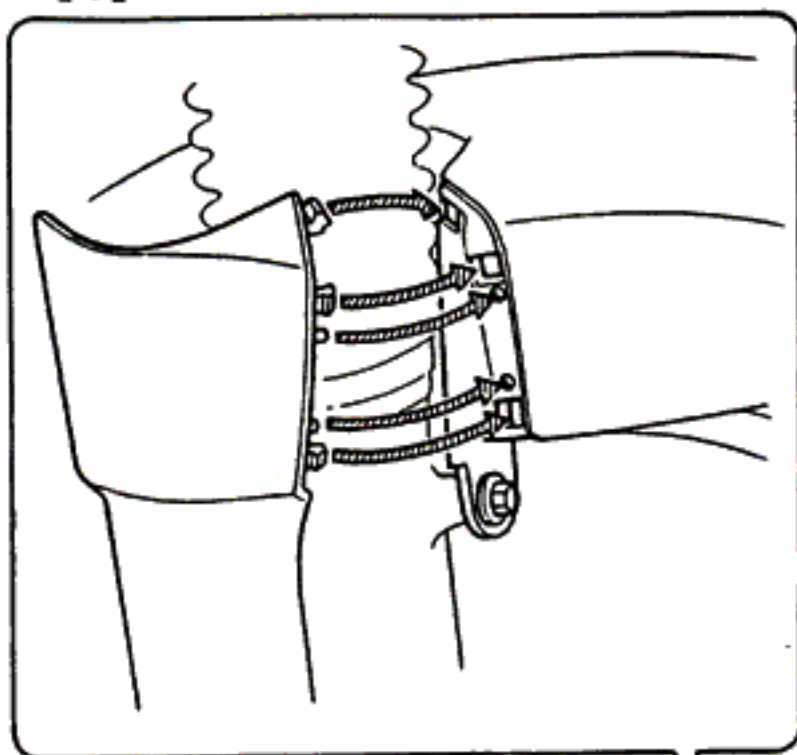

[3]

[4]

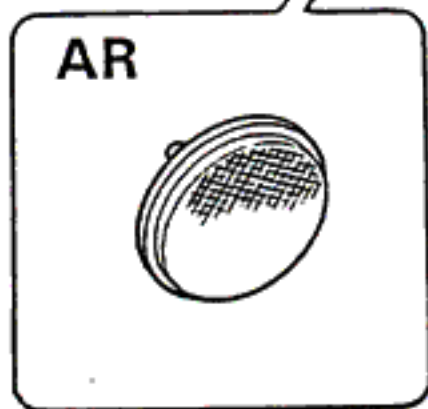

[2]

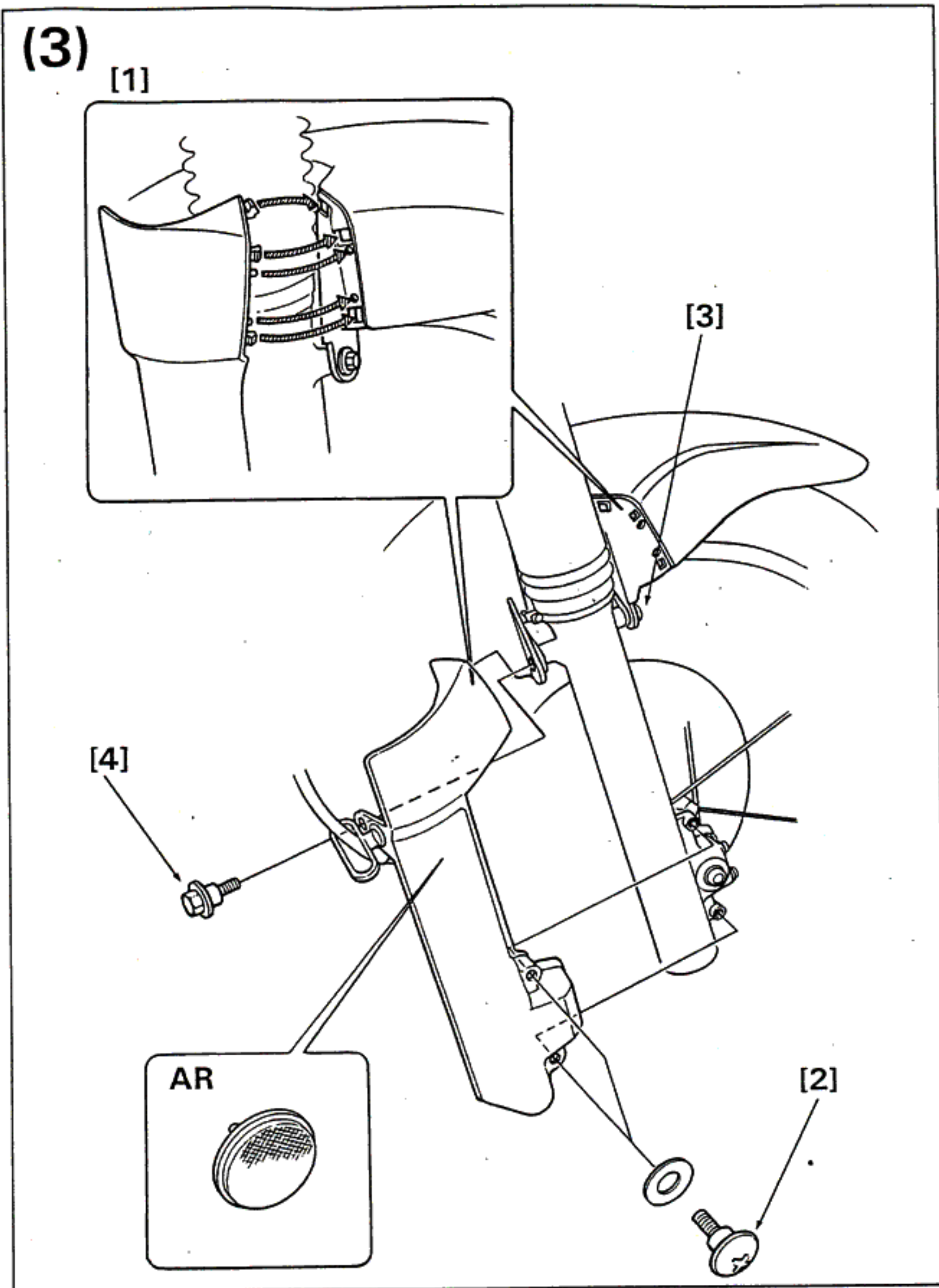

(4) [1]

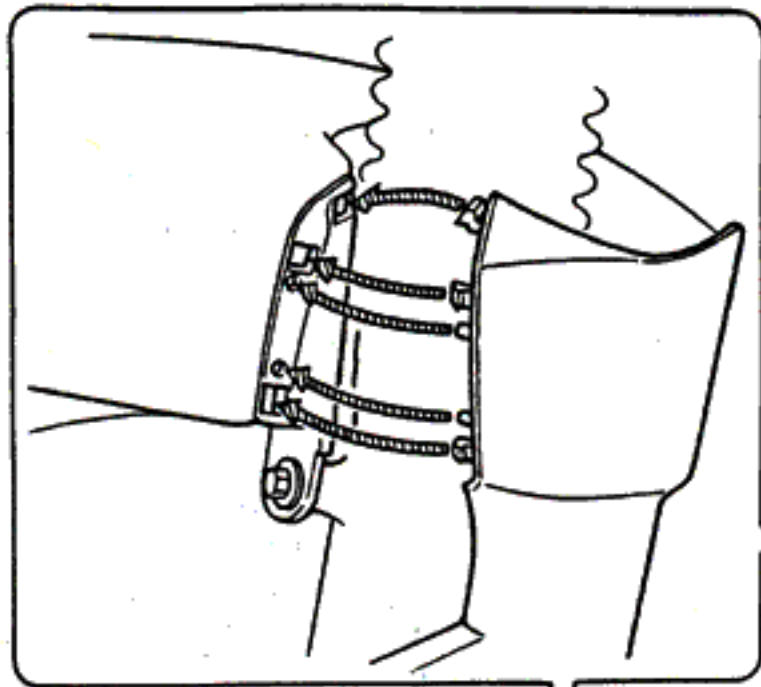

[3]

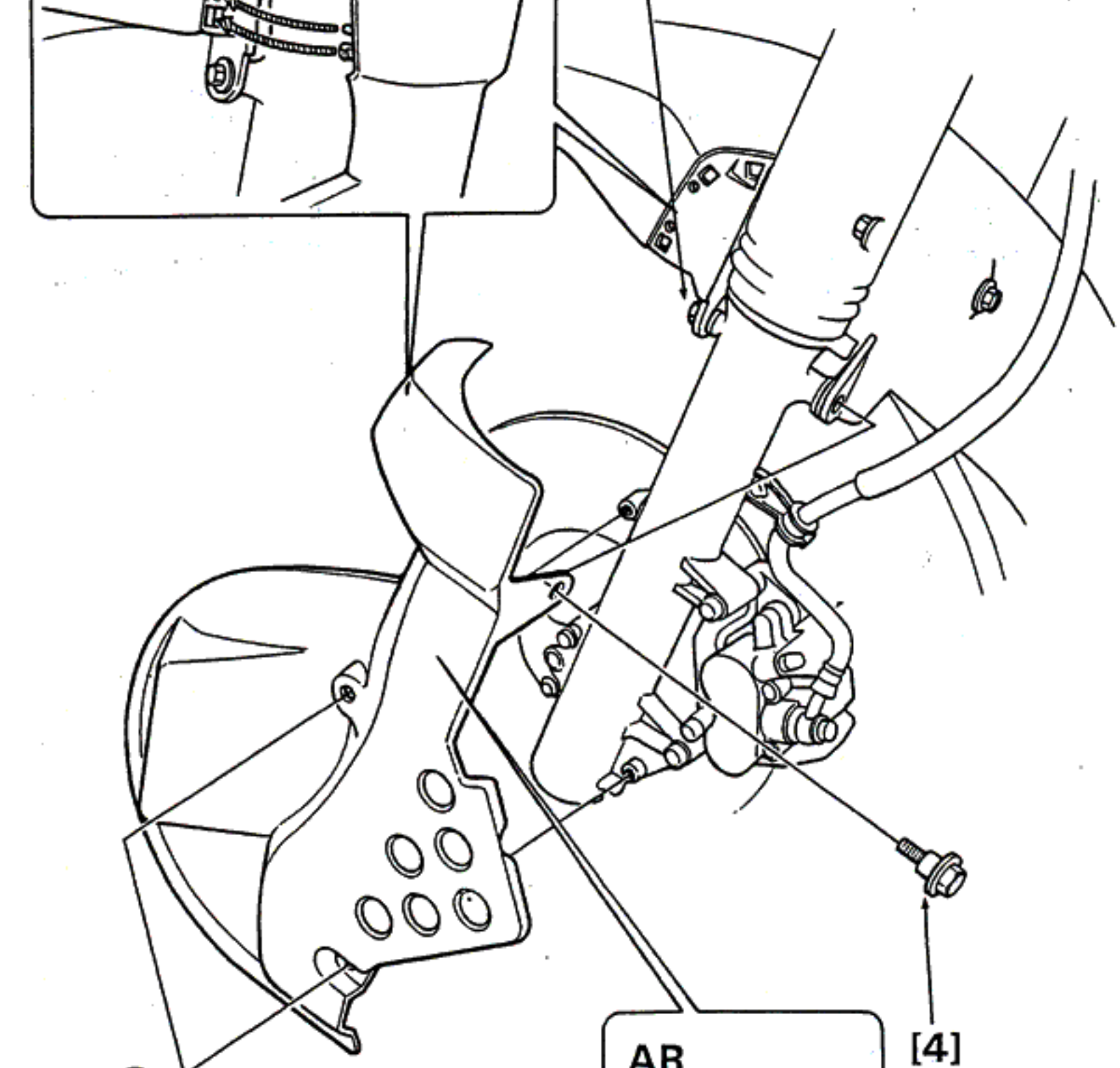

AR

[4]

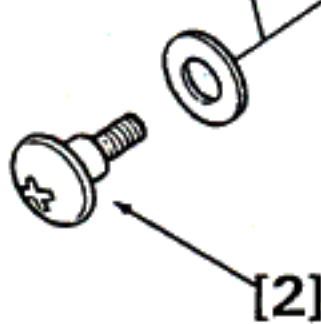
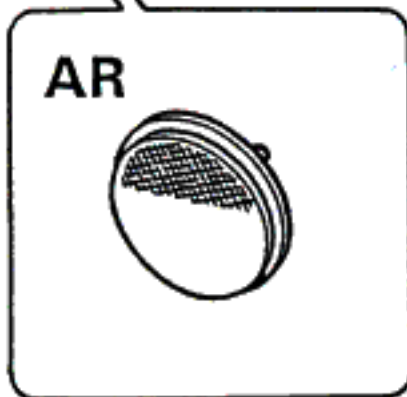

[2]

(5)

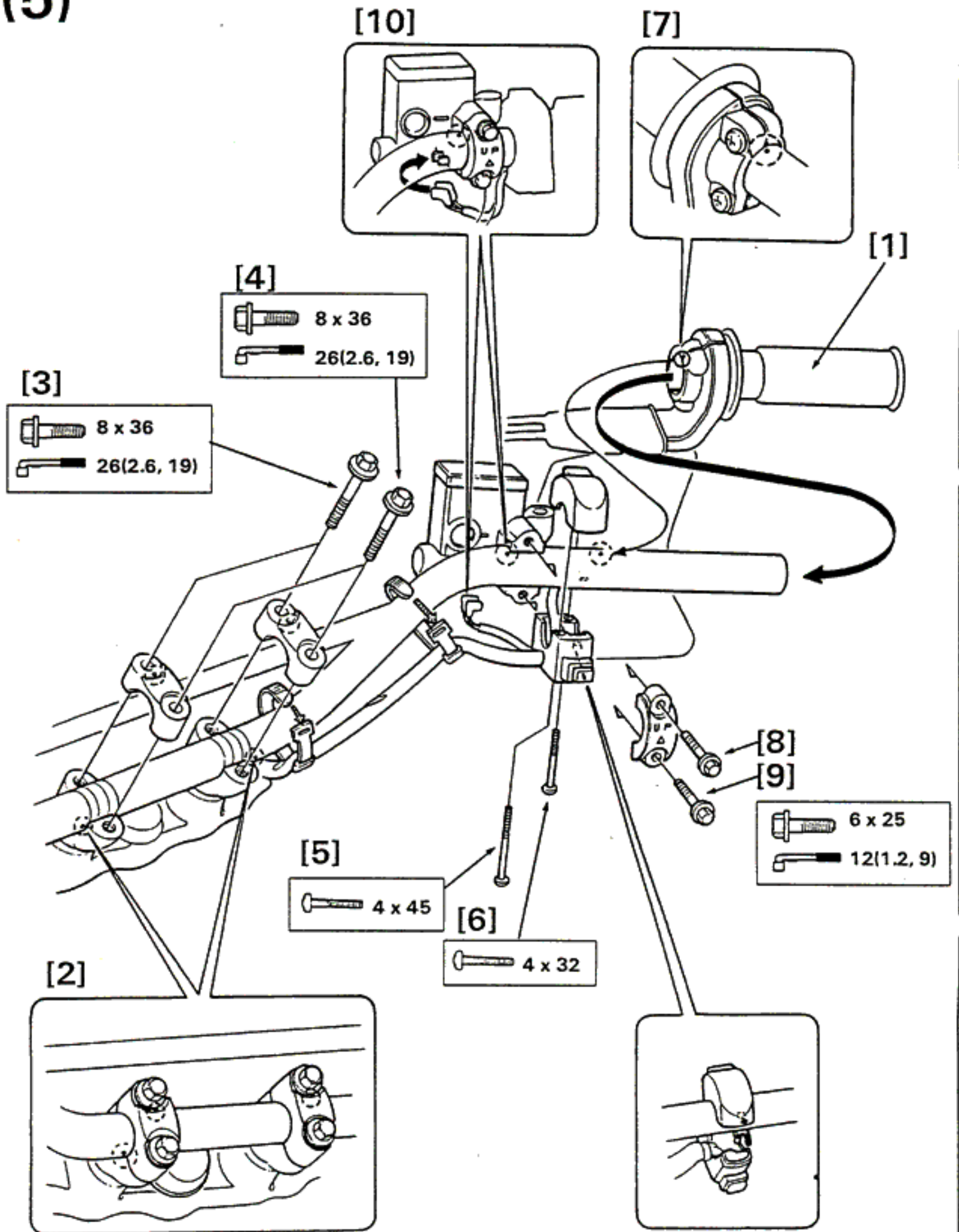

(6)

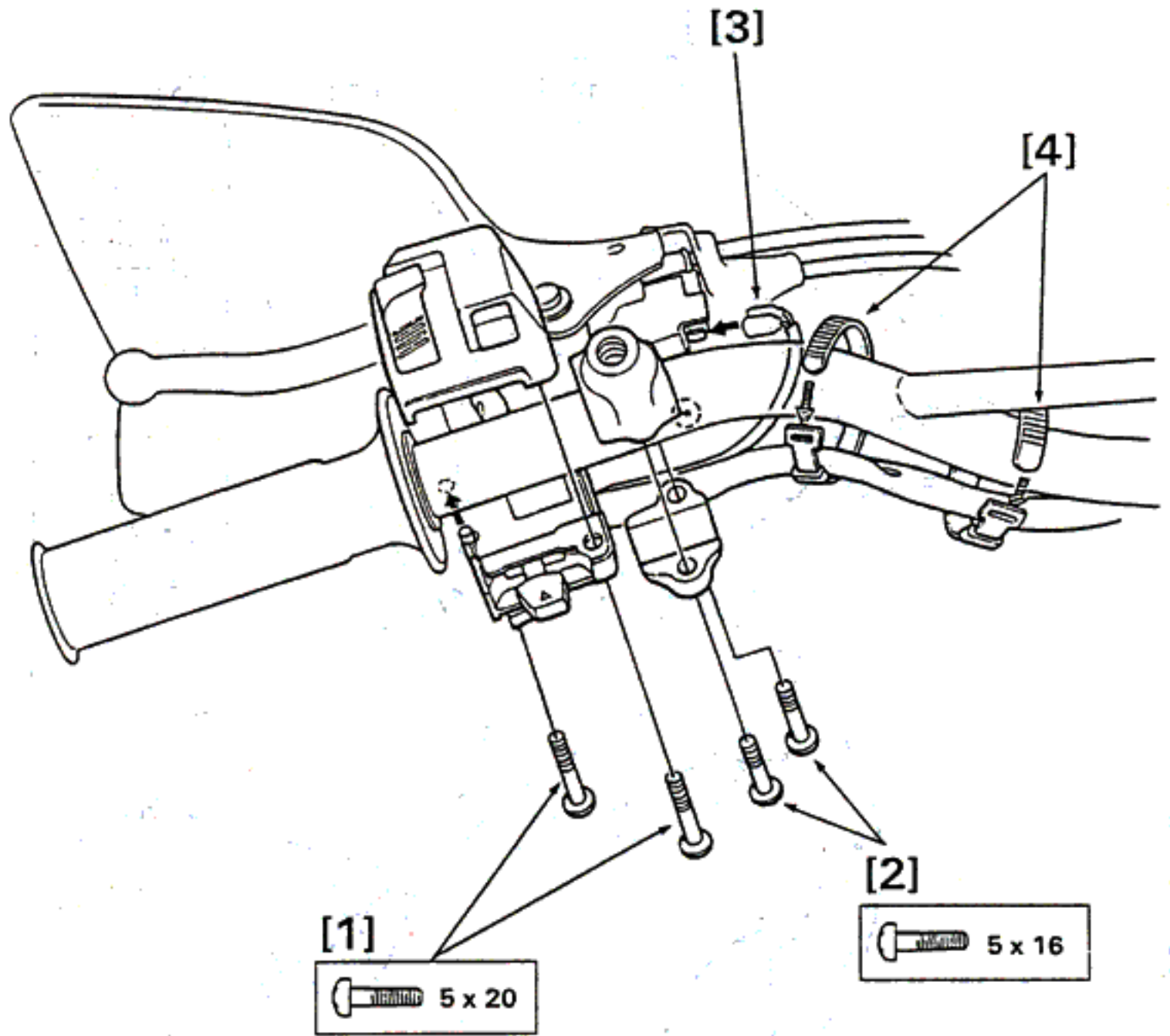

(7)

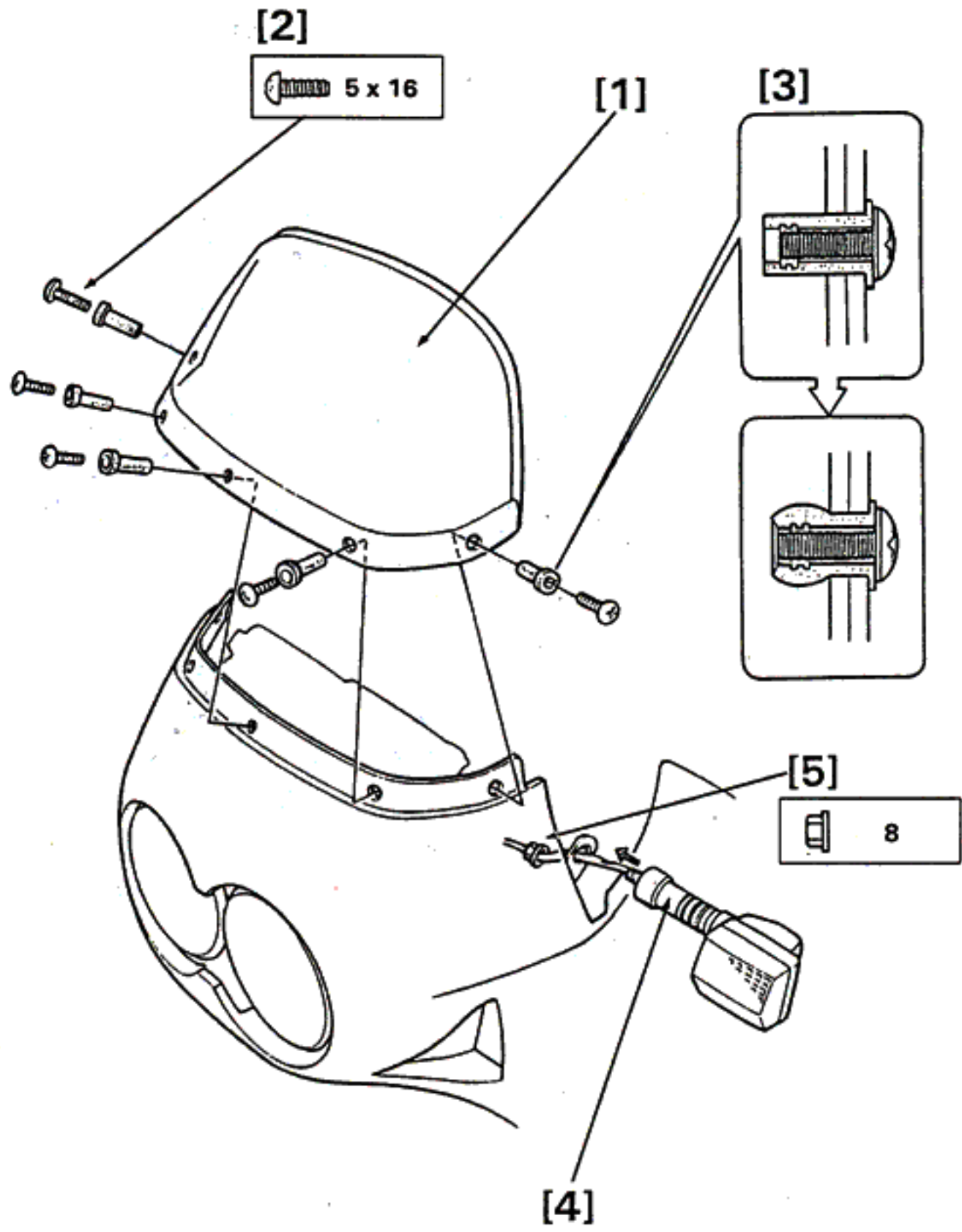

(8)

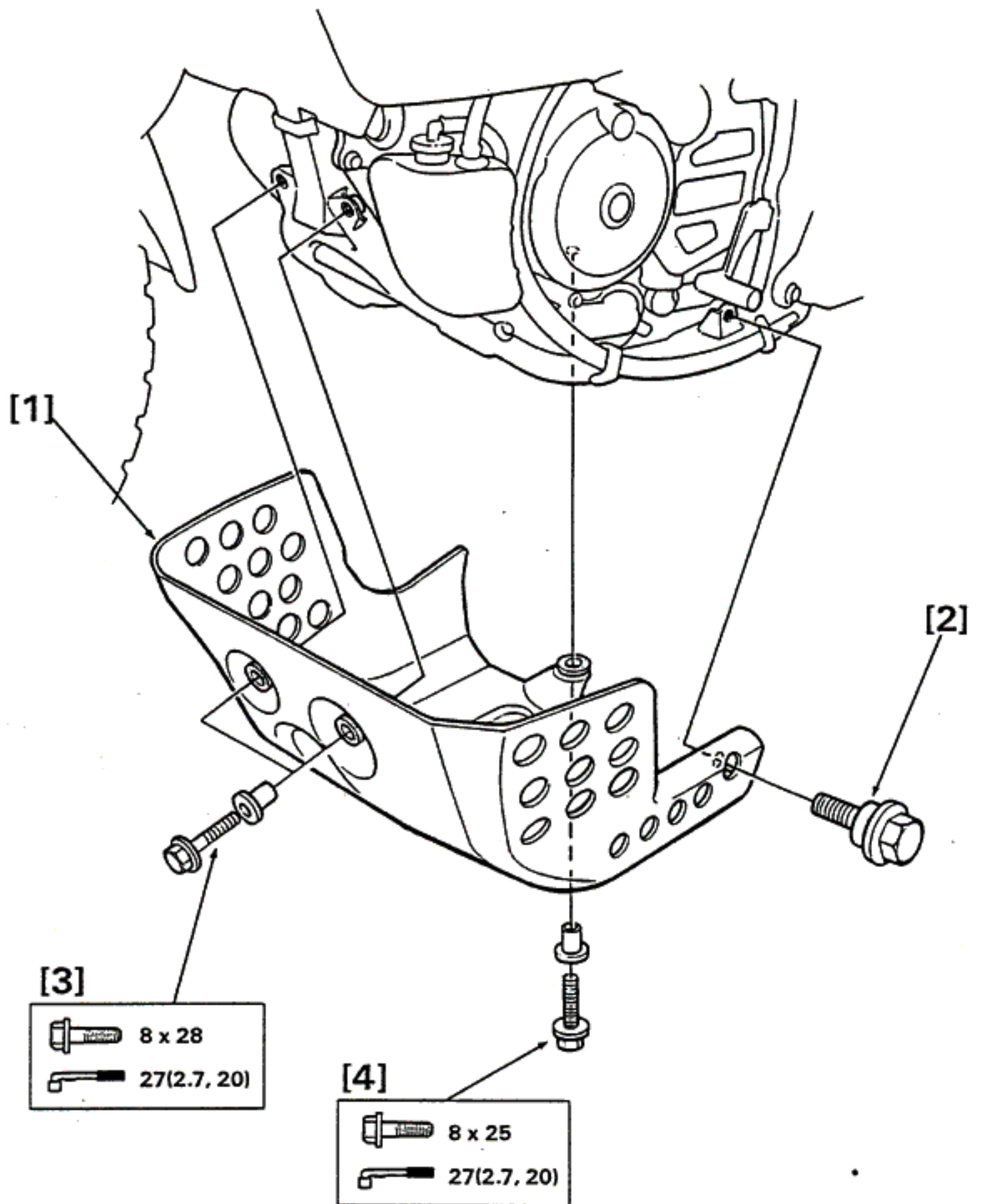

(9)

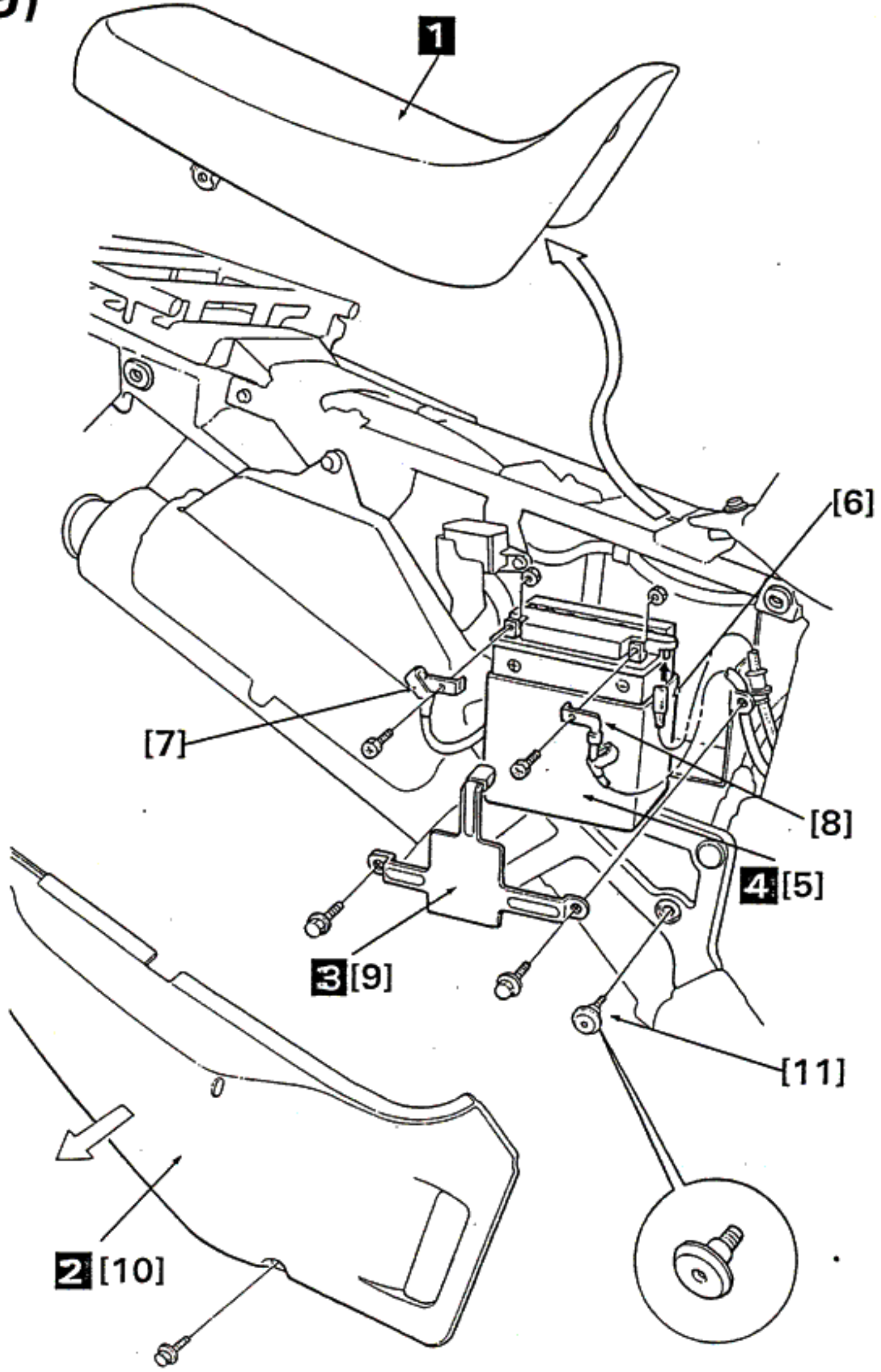

(10) [4]

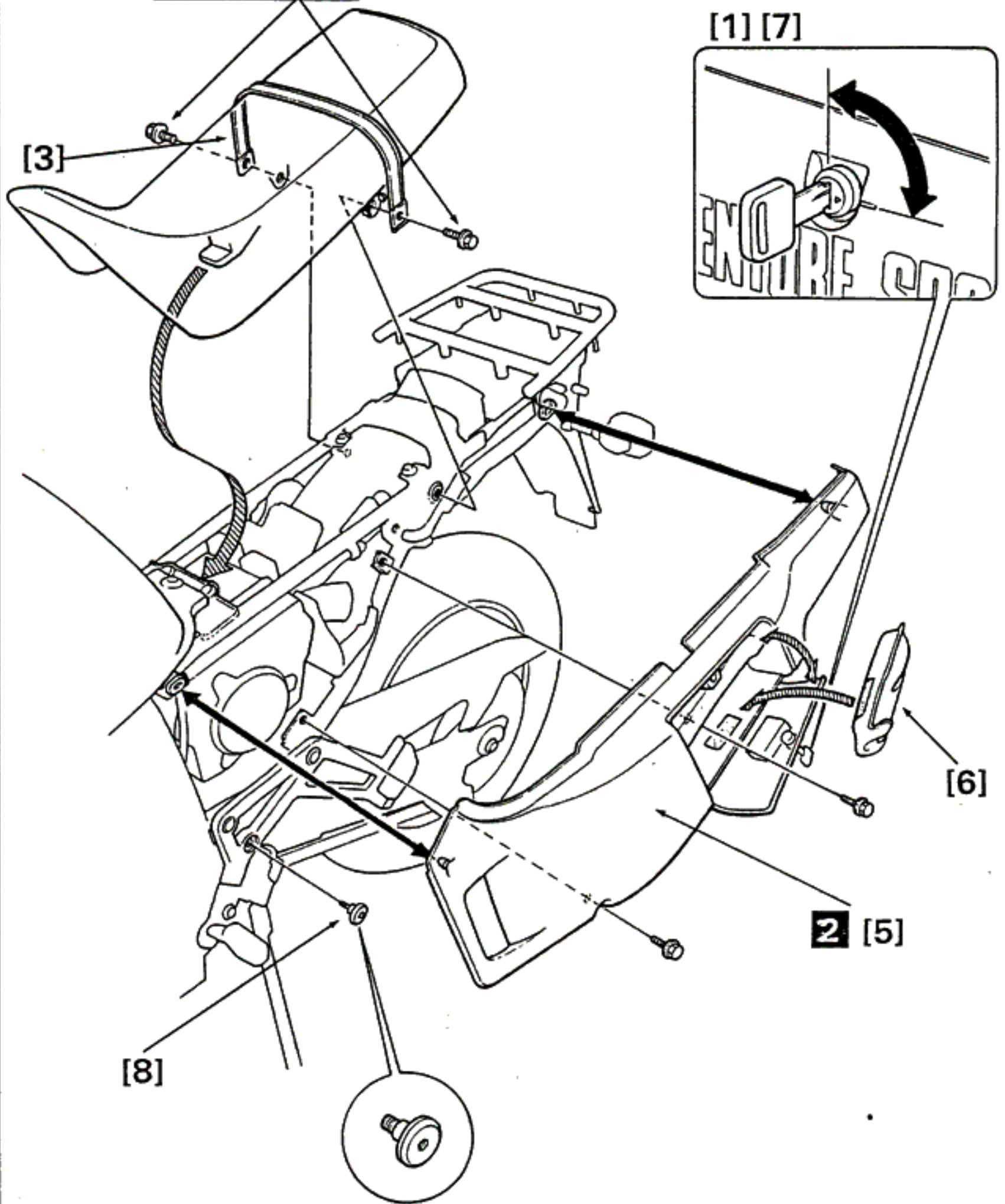
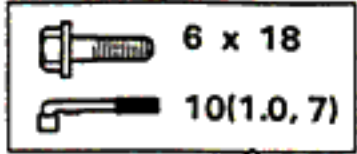

(11)

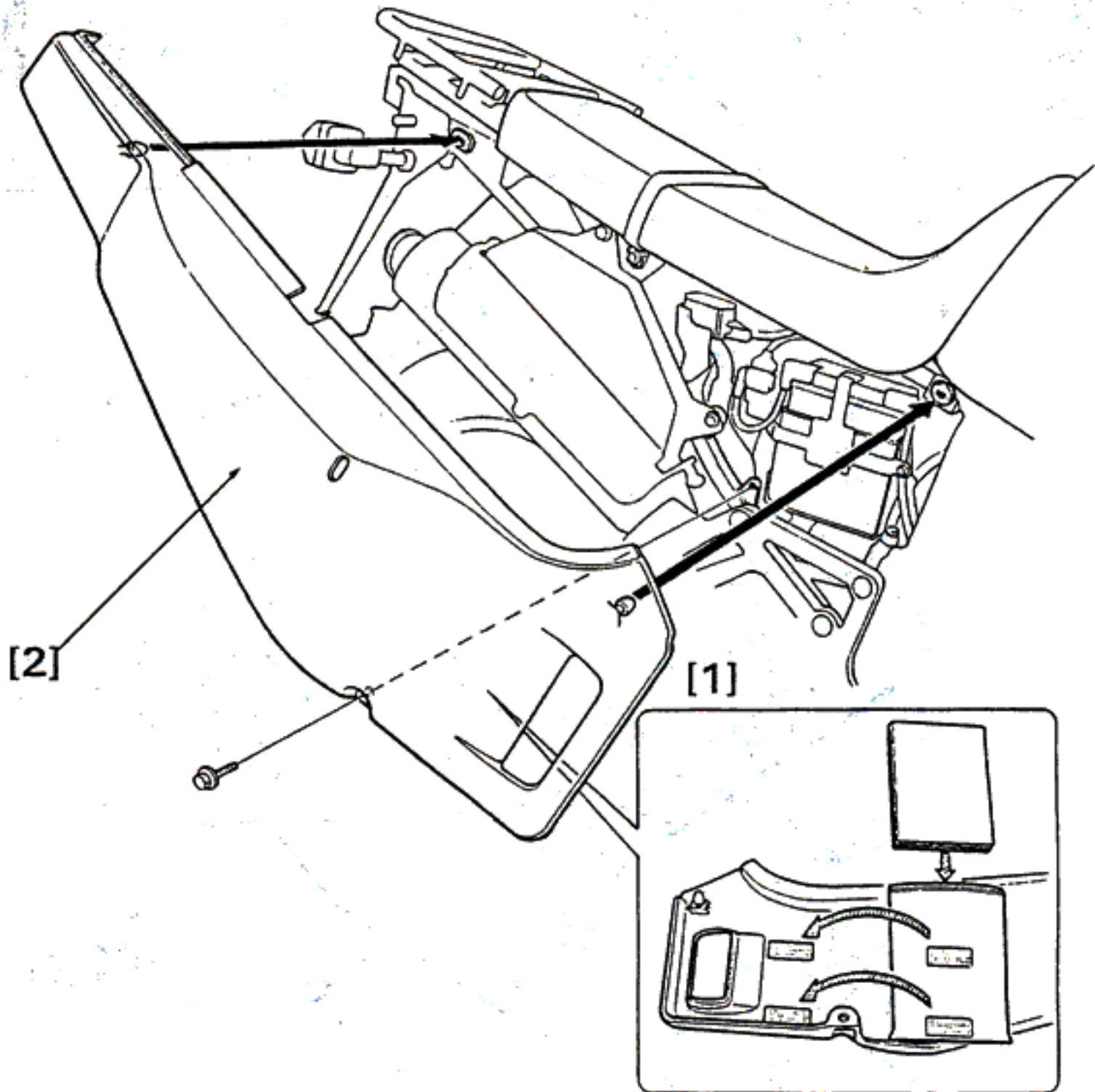

(12)

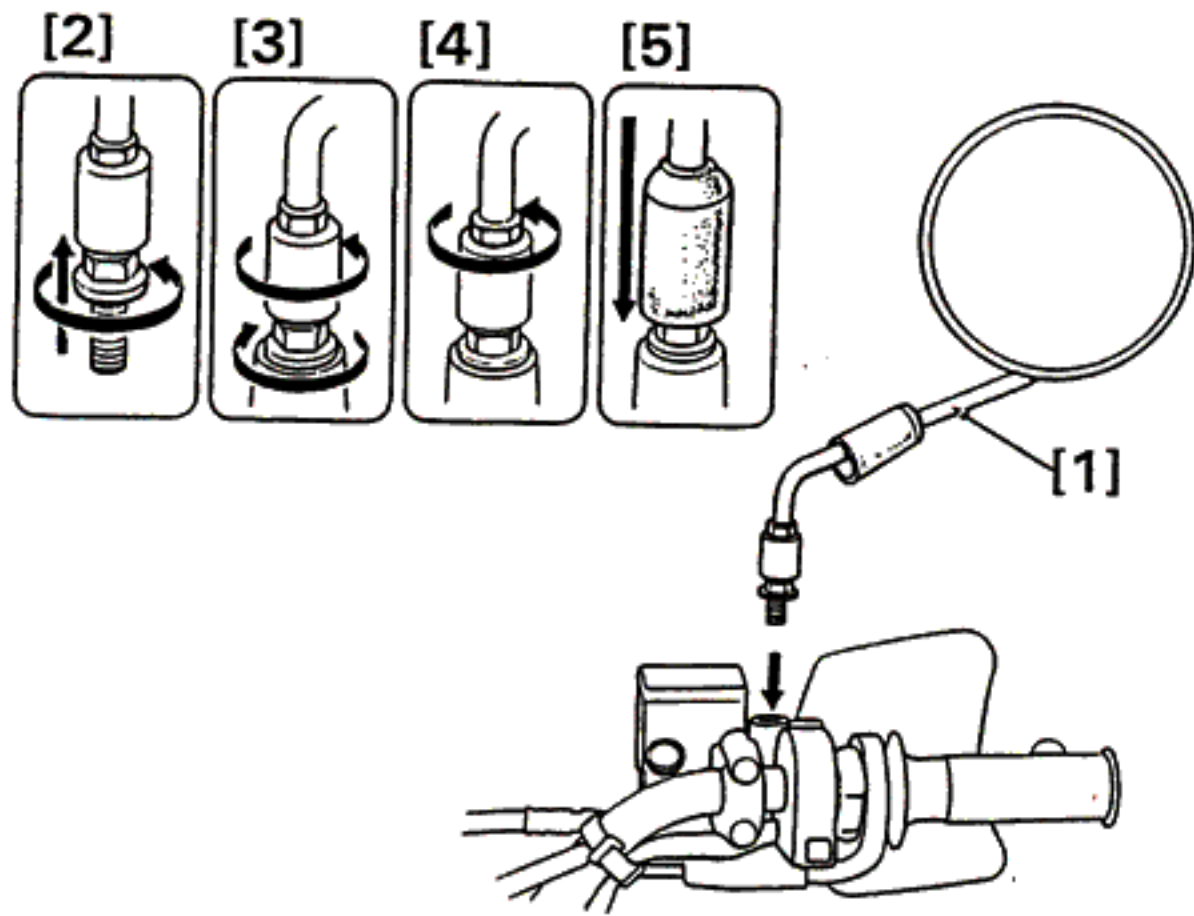

(13) : SW FI

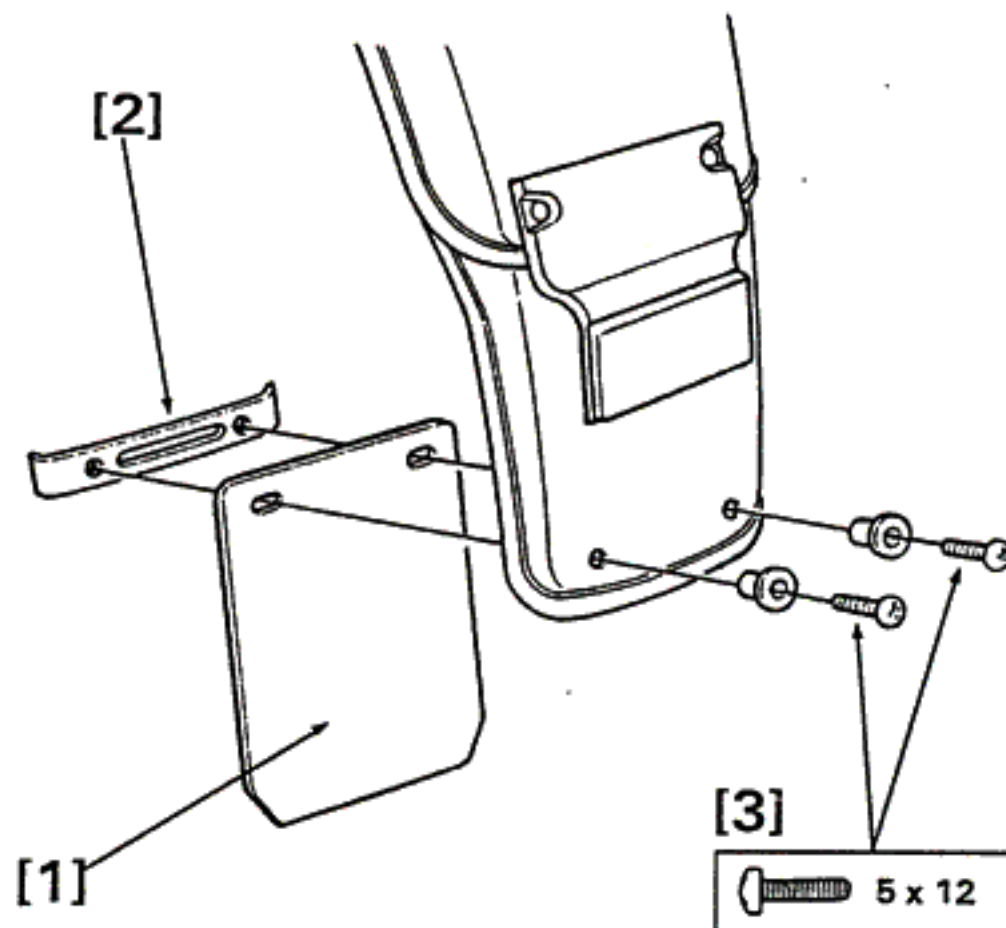



HONDA
HONDA MOTOR CO., LTD. TOKYO, JAPAN